

A decorative graphic on the left side of the slide, consisting of a network of orange lines and circles that resemble a circuit board or a stylized tree structure.

# TABLETS 101

EVERYTHING YOU NEED TO KNOW

ABOUT OPERATING YOUR NEW TABLET

# IDENTIFYING YOUR TABLET



# IDENTIFYING YOUR TABLET

KINDLE



# IDENTIFYING YOUR TABLET

NOOK (SAMSUNG)



Samsung  
GALAXY **Tab**

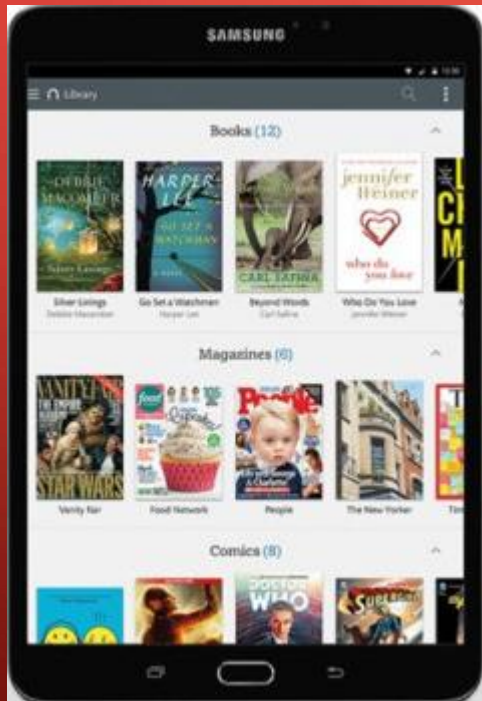

# ORIENTATION

## PORTRAIT V. LANDSCAPE



- SOME APPS ARE AUTOMATICALLY FORMATTED FOR PORTRAIT OR LANDSCAPE
- SOME APPS HAVE A DIFFERENT APPEARANCE OR PERFORMANCE DEPENDING ON WHICH WAY YOU HOLD THE DEVICE
- IF YOU WANT TO YOU CAN USUALLY LOCK THE ORIENTATION IN OPTIONS OR SETTINGS



# NAVIGATION

## TOUCH

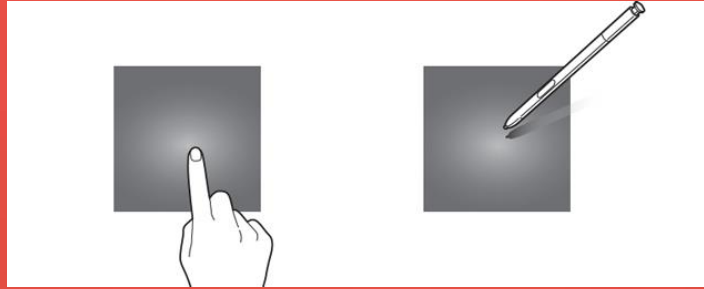

- LIKE A MOUSE CLICK IT IS USED TO SELECT OR OPEN FUNCTIONS, PROGRAMS, OR APPS.
- TAPPING YOUR SCREEN CAN HAVE DIFFERENT EFFECTS IN DIFFERENT APPS.
- FOR EXAMPLE IF YOU ARE WATCHING A VIDEO, TAPPING WILL OFTEN PAUSE IT.



# NAVIGATION

## TOUCH & HOLD

BY HOLDING A TOUCH FOR A FEW SECONDS YOU CAN:

- HIGHLIGHT TEXT TO COPY OR LOOK UP
- BRING UP MENUS (IN SOME APPS)

# NAVIGATION

## SWIPE

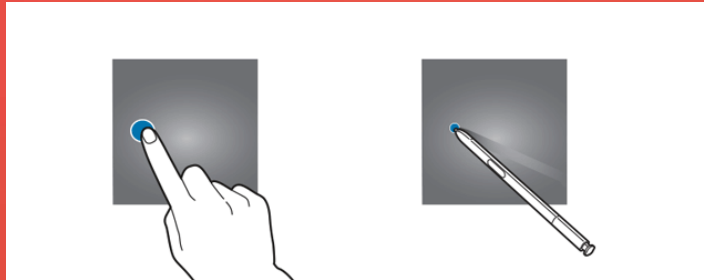

- SWIPING CAN NAVIGATE YOU THROUGH A LIST,  
OR ONTO DIFFERENT PAGE OF APPS,
- TURN THE PAGE ON A E-BOOK
- PERFORM SPECIFIC FUNCTIONS IN DIFFERENT APPS.
- SWIPING CLOSE TO THE TOP OR BOTTOM OF YOUR  
SCREEN WILL OFTEN OPEN MENUES.



# NAVIGATION

## ZOOM

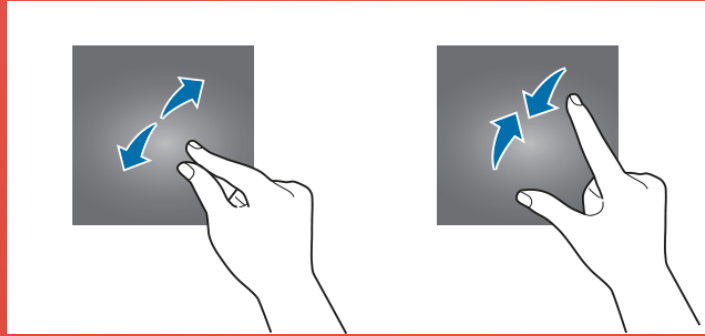

- FINGERS APART TO ZOOM IN
- FINGERS TOGETHER TO ZOOM OUT

# NAVIGATION

## TYPING

- ONCE YOU TOUCH A FIELD THAT ACCEPTS TEXT, THE KEYBOARD SHOULD POP UP

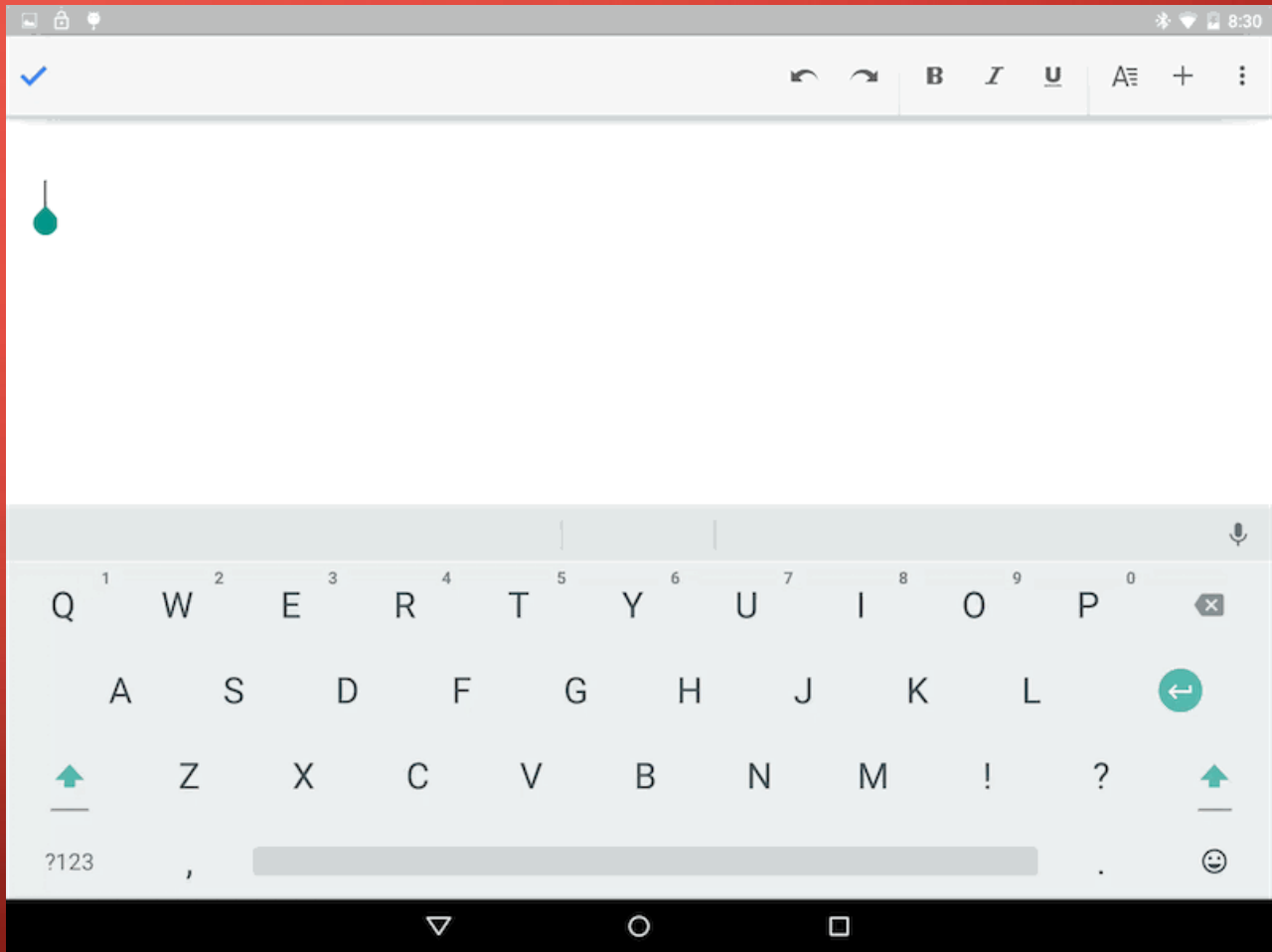



# WHAT CAN MY TABLET DO?

## FUNCTION VS APPS

Most tablets come with some functions built in...

Settings

Wifi

Bluetooth

Notifications

Contacts

Keyboard

Docs

Photo storage



# WHAT CAN MY TABLET DO?

## FUNCTION VS APPS

...but most programs are application (apps)

Some apps come preloaded, but many must be purchased (even if they are free)

# TABLETS 101

Some devices have an app procuring program built in as a tab or button such as “store”, “apps” iTunes or google play

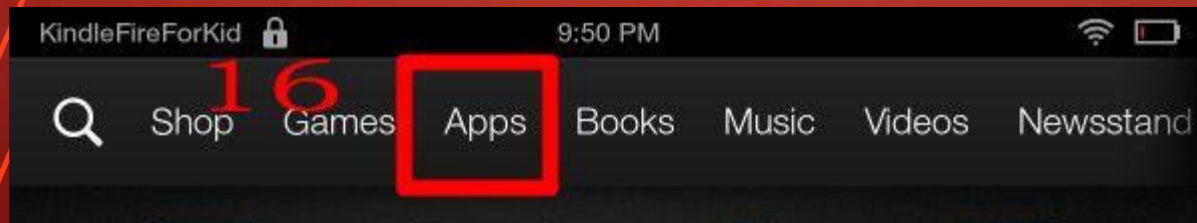

Google Play



Play Store



Play Movies & TV

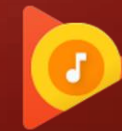

Play Music



Play Games



Play Books



Play Newsstand



# TABLETS 101

Common apps you may be interested in :

media players:



Games:



Social media:





# TABLETS 101

## STORAGE

- Your devices has limited storage.
- You can only store a certain amount of programs and media on the device at a time.
- Depending on how you purchased something, you may be able to delete or uninstall it with the ability to re-download or re-install later.

A decorative graphic on the left side of the slide, consisting of a network of orange lines and circles resembling a circuit board or a stylized tree structure.

# TABLETS 101

## STORAGE

- Many Apple and Amazon devices tend to not allow extra storage to be added.
- Many Nook, Samsung, Android or other 3<sup>rd</sup> party devices do allow extra storage via standard, mini or micro SD cards



# TABLETS 101

## STORAGE

- You could also move files  
(photos, media, documents)  
To other devices such as desk top or laptop

A decorative graphic on the left side of the slide, consisting of a network of orange lines and small circles, resembling a circuit board or a stylized tree structure.

# TABLETS 101

## OTHER CONSIDERATIONS...

- Security: who else has access to my device, do I need security?
- Durability: do I need a screen protector and/or protective case?





# TABLETS 101

## OTHER CONSIDERATIONS...

Like email or anything else online;  
try to stick to usernames and passwords you can  
remember...  
and then write them down somewhere anyway.

A decorative graphic on the left side of the slide, consisting of a network of orange lines and circles resembling a circuit board or a stylized tree structure.

# TABLETS 101

## OTHER CONSIDERATIONS...

- Learning the ins and outs of your device can be a trial and error process. Explore you menus and settings to determine what you can do.
- If you cant figure out how to undo something, you can reset to factory settings



# TABLETS 101

EVERYTHING YOU NEED TO KNOW  
ABOUT OPERATING YOUR NEW TABLET

**Tablets 101:** (ipads)

Possible resources:

<https://www.gcflearnfree.org/computerbasics/mobile-devices/1/>



# TABLETS 101

EVERYTHING YOU NEED TO KNOW

ABOUT OPERATING YOUR NEW TABLET

MONDAY SEPTEMBER 11<sup>TH</sup> @ 3PM